

Road Map



Hybrid Map



Terrain Map



Floor Plan

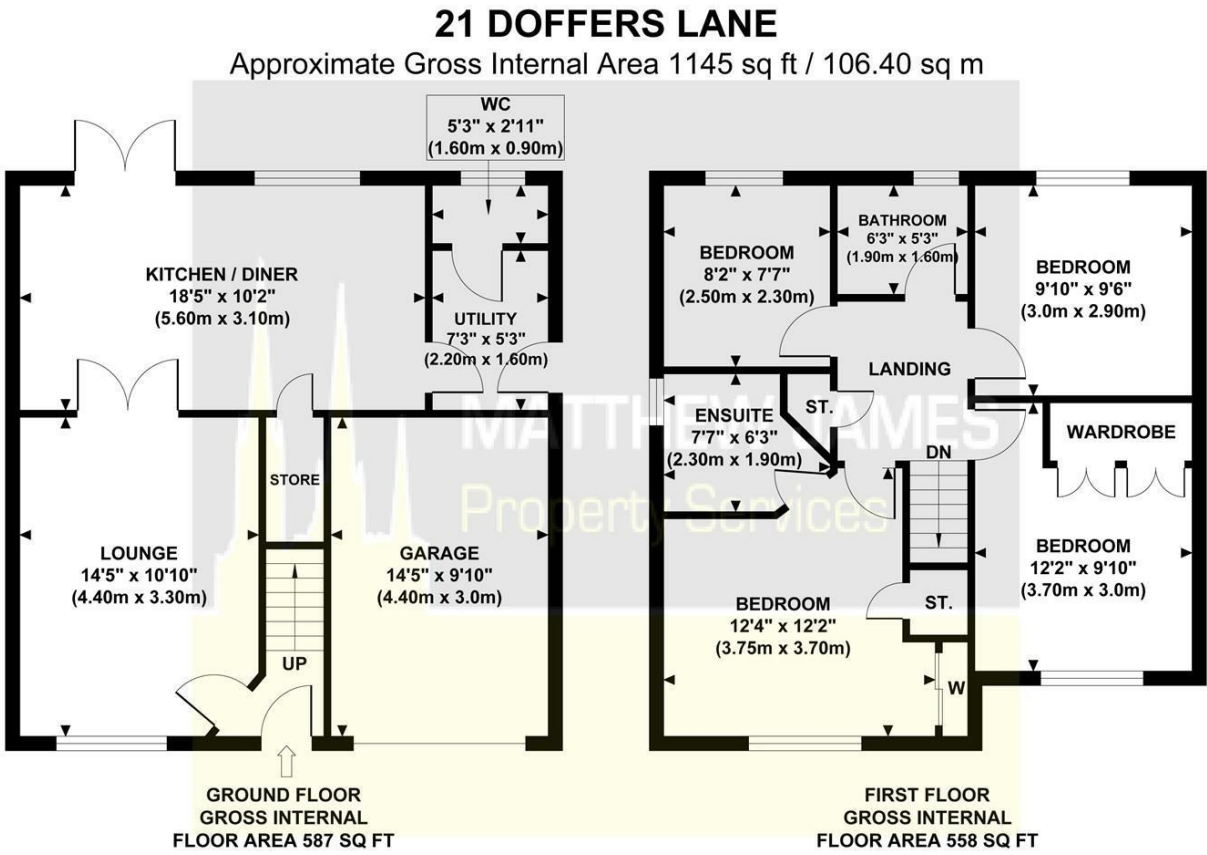

Viewing

Please contact us on 02477 170170 if you wish to arrange a viewing appointment for this property or require further information.

These particulars, whilst believed to be accurate are set out as a general outline only for guidance and do not constitute any part of an offer or contract. Intending purchasers should not rely on them as statements of representation of fact, but must satisfy themselves by inspection or otherwise as to their accuracy. No person in this firms employment has the authority to make or give any representation or warranty in respect of the property.

CONTACT INFORMATION

24a Warwick Row, Coventry CV1 1EY  
02477 170170

info@matthewjames.uk.com  
www.matthewjames.uk.com

Facebook  
Twitter

**MATTHEW JAMES**  
Property Services



**21 Doffers Lane**  
Paragon Park, Foleshill, Coventry CV6 5FZ

Offers Over £350,000

4 2 1 B





# 21 Doffers Lane

Paragon Park, Foleshill, Coventry CV6 5FZ

Offers Over £350,000



Approach / Driveway

Entrance Hallway

Lounge  
14'5 x 10'10

Kitchen/Diner  
18'5 x 10'2

Utility Room  
7'3 x 5'3

W.C  
5'3 x 2'11

Landing

Master Bedroom  
12'4 x 12'2

En-Suite  
7'7 x 6'3

Bedroom Two  
12'12 x 9'10

Bedroom Three  
9'10 x 9'6

Bedroom Four  
8'2 x 7'7

Bathroom  
9'10 x 9'6

Rear Garden

Garage  
14'5 x 9'10

